

F

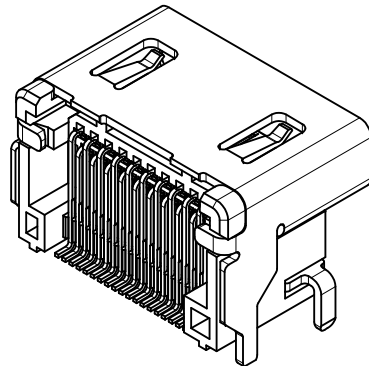
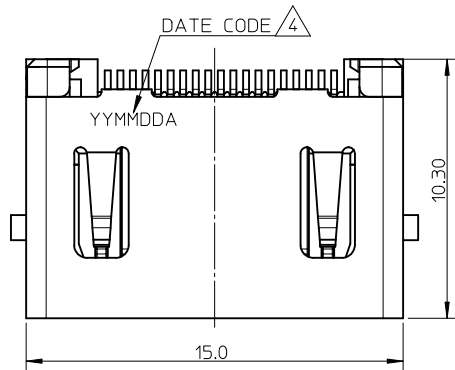

NOTES:

- MATERIAL:
HOUSING: HIGH TEMPERATURE THERMAL PLASTIC. COLOR: BLACK.
SHELL/PEG: COPPER ALLOY.
TERMINAL: COPPER ALLOY.
- PLATING:
TERMINAL:
CONTACT AREA: SEE TABLE.
SOLDER AREA: 1 MICRON MIN. TIN-BISMUTH PLATING.
UNDER PLATE: 1.27 MICRON MIN. NICKEL PLATING.
SHELL/PEG: 1.27 MICRON MIN. SOLDERABLE NICKEL PLATING OVER 0.75 MICRON NICKEL PLATING OVERALL.
- COPLANARITY OF ALL TERMINALS IS 0.10mm MAX.
- \triangle 4 DATE CODE: 'YYMMDDA', 'YY' REPRESENTS YEAR, 'MM' REPRESENTS MONTH, 'DD' REPRESENTS DATE, 'A' REPRESENTS SHIFT.
- PRODUCT SPECIFICATION: PS-105156-001, TBA FOR PD/NI OPTION.
- PACKAGE SPECIFICATION: PK-105156-001.
- PRODUCT COMPLIANT TO RoHS DIRECTIVE 2002/95/EC AND ELV DIRECTIVE 2000/53/EC.

E

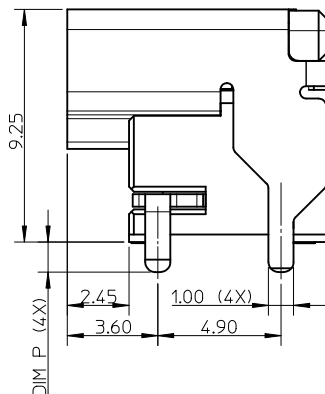
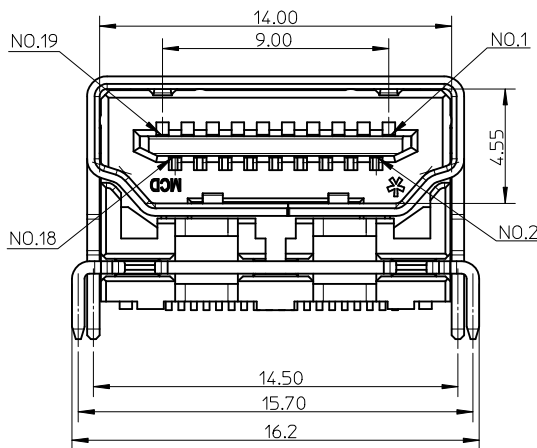

| | | |
|-------------|-------------------------------|------------|
| 105156-1009 | GOLD FLASH OVER PD/NI | |
| 105156-1006 | 0.76 MICRON MIN. GOLD PLATING | 1.20 |
| 105156-1007 | 0.38 MICRON MIN. GOLD PLATING | |
| 105156-1008 | GOLD FLASH | |
| 105156-1108 | GOLD FLASH | 1.00 |
| P/N | CONTACT AREA PLATING | DIM P±0.15 |

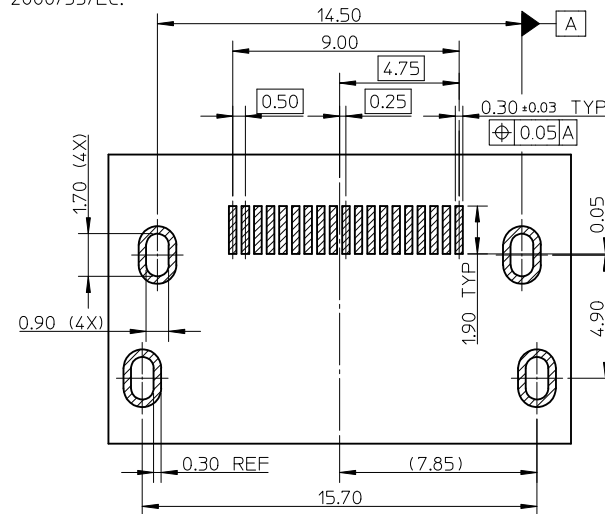

RECOMMENDED PCB LAYOUT (CONNECTOR SIDE)
THICKNESS=1.20mm, GENERAL TOLERANCE: ±0.10

B

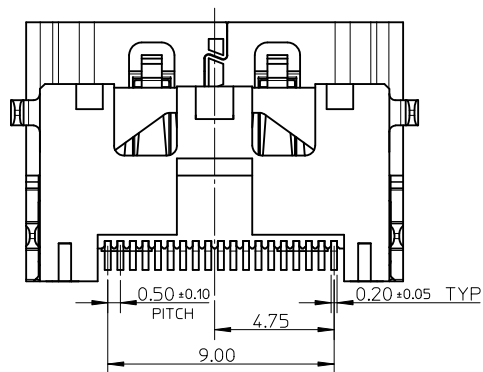

| | | | | | | | | | | |
|--|------------|-------------|-----------------|--|------|-----------------|------------|---|--------------|------------------------|
| ADD NEW P/N EC NO: S2012-0578 DRWN: JZENG CHKD: JESSIECHUA APPR: MAOESHKIN | 2012/01/31 | DESCRIPTION | QUALITY SYMBOLS | GENERAL TOLERANCES (UNLESS SPECIFIED) | | DIMENSION STYLE | | SCALE | DESIGN UNITS | THIRD ANGLE PROJECTION |
| | 2012/03/15 | | $F_A=0$ | mm | INCH | MM ONLY | NTS | METRIC | | |
| | 2012/03/19 | | $F_G=0$ | 4 PLACES ± --- ± --- | | DRAWN BY | DATE | TITLE | | |
| | | | $F_P=0$ | 3 PLACES ± --- ± --- | | XQZHANG | 2010/05/28 | SD DRAWING FOR HDMI RECEPTACLE RIGHT ANGLE TYPE | | |
| | | | | 2 PLACES ± 0.20 ± --- | | CHECKED BY | DATE | MOLEX INCORPORATED | | |
| | | | | 1 PLACE ± 0.30 ± --- | | APPROVED BY | DATE | DOCUMENT NO. SD-105156-100 | | |
| | | | | ANGULAR ± 1 ° | | MATERIAL NO. | | SHEET NO. | | |
| | | | | DRAFT WHERE APPLICABLE MUST REMAIN WITHIN DIMENSIONS | | SEE TABLE | | 1 OF 1 | | |
| A4 | | REV | | | | SIZE A3 | | THIS DRAWING CONTAINS INFORMATION THAT IS PROPRIETARY TO MOLEX INCORPORATED AND SHOULD NOT BE USED WITHOUT WRITTEN PERMISSION | | |