

## 1 Verify kit contents

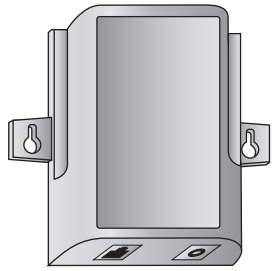

ConnectPort X2

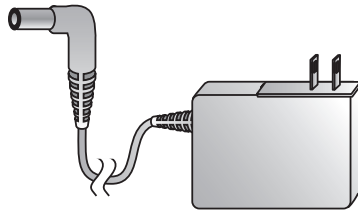

Power supply

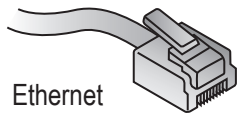

Ethernet cable



## Quick Start Guide

### ConnectPort™ X2 for Smart Energy



(1P):90001121-88 B

## 2 Connect hardware

**a** Connect Ethernet cable to LAN connection

**b** Connect power supply

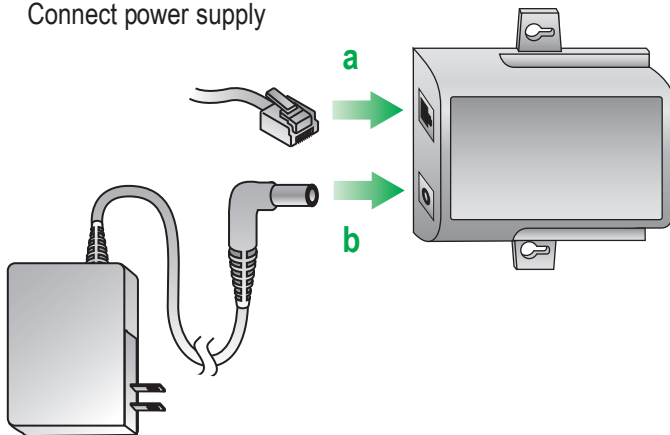

## 3 Download documentation

Digi offers complete documentation, example applications, and source code for the Smart Energy Framework to help you take the next step in customizing your application. To access the step-by-step guide, go to [www.digi.com/X2SE](http://www.digi.com/X2SE).